

ORDERING EXAMPLE

For Example **1** **V** **G** **2** **U**  

SERIES TYPE FLANGE SHAFT PORT DISPL. ROTATION

If you need pump with displ.0.31 c.i.r and rotation is cw, the model number is: **1VG2U05R**

PERFORMANCE DATA

MODEL	DISPLACEMENT		PRESSURE psi(MPa)		RPM RANGE	DIMENSIONS inch(mm)		WEIGHT	
	c.i.r	cm ³ /r	CONTINUOUS	MAX.		A	L	Kg	LBS
01	0.08	1.3	3000(21)	3600(25)	600	1.655(42.0)	4.216(107.1)	2.47	5.43
02	0.12	2.0	3000(21)	3600(25)		1.694(43.0)	4.294(109.1)	2.51	5.52
27	0.16	2.7	3000(21)	3600(25)		1.734(44.0)	4.373(111.1)	2.55	5.61
35	0.21	3.4	3000(21)	3600(25)		1.773(45.0)	4.452(113.1)	2.58	5.68
04	0.25	4.1	3000(21)	3600(25)	4000	1.813(46.0)	4.531(115.1)	2.62	5.76
05	0.31	5.1	3000(21)	3600(25)		1.872(47.5)	4.649(118.1)	2.67	5.87
06	0.37	6.1	3000(21)	3600(25)		1.931(49.0)	4.767(121.1)	2.72	5.98
07	0.45	7.4	2850(20)	3300(23)		2.009(51.0)	4.924(125.1)	2.78	6.12
09	0.55	9.1	2550(18)	2850(20)	600 (*1)2500	2.108(53.5)	5.121(130.1)	2.86	6.29
11	0.67	11.0	2300(16)	2550(18)		2.226(56.5)	5.358(136.1)	2.95	6.49
13	0.82	13.5	2300(16)	2550(18)		2.364(60.0)	5.634(143.1)	3.06	6.73

*More than 2500 qualified per applications.

Code	PORTS			
	From "01" to "06"		From "07" to "13"	
	INLET	OUTLET	INLET	OUTLET
U	UNF#8 3/4"-16	UNF#6 9/16"-18	UNF#10 7/8"-14	UNF#8 3/4"-16
P	PT 1/2"	PT 3/8"	PT 3/4"	PT 1/2"
N	NPT 1/2"	NPT 3/8"	NPT 3/4"	NPT 1/2"
B	BSPF 1/2"	BSPF 3/8"	BSPF 3/4"	BSPF 1/2"

OVERALL DIMENSIONS

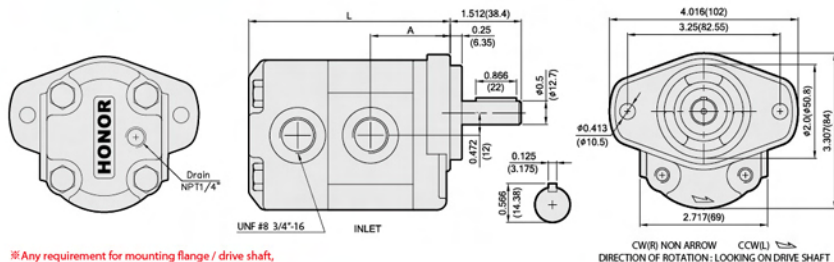

※ Any requirement for mounting flange / drive shaft, please refer to 1G series specifications

CW(R) NON ARROW CCW(L) 
DIRECTION OF ROTATION: LOOKING ON DRIVE SHAFT