

SOLENOID OPERATED CHECK VALVES

LVSP-02G

電磁止回閥

◆ MODEL 型號

LVSP-02G



◆ SPECIFICATIONS 規格

| Model Number 型號 | Maximum Pressure 最大壓力 bar | Maximum Flow 最大流量 lpm | Weight 重量 Kg |
|-------------------------------|--------------------------------|-----------------------|----------------|
| LVSP-02G | 250 (3625psi) | 35 (8.81 gpm) | 1.3 (2.87 lbs) |
| Fluid Type 液體 | ISO VG 32, 46, 68 | | |
| Viscosity 黏度 cSt | 10-400 (50-1854 SSU) | | |
| Operating Temperature 工作溫度 °C | -15~70 (-5~158° F) | | |
| Contamination Level 污染度 | ISO4406:21/15/10 NAS1638:10 | | |
| Surface Treatment 表面處理 | Zinc Phosphate Compound 磷酸鹽化合物 | | |

◆ All screws with metric measure , if require inch measure , please contact us.

◆ 所有螺絲均為公制規格，如需英制規格請洽本公司。

◆ HOW TO ORDER 如何訂購

| 1 | 2 | 3 | 4 | 5 |
|------|------|---|------|------|
| LVSP | — 02 | G | — ** | — 20 |

1 VALVE SERIES 閥系列

LVSP= SOLENOID OPERATED TWO-WAY CHECK VALVES

2 SUBPLATE MOUNTING SIZE: 副板安裝尺寸

D2 = 14" (35mm)
ISO CETOP3
DIN NG 6
NFFA D03

3 CONNECTING TYPE 連接類型

G: TYPE-BASEPLATE MOUNTING TYPE

□: 螺式連接

4 TYPE OF COIL 電磁線圈類型

A1 : AC110 50HZ D1 : DC12
A110 : AC110 50HZ D0 : DC24
A230 : AC230 50HZ R1 : RP110 50HZ/50HZ
A2 : AC220 50HZ R2 : RP220 50HZ/50HZ

5 CONTROL WAY 控制方式

Please consider another control methods of this Wang's cartridge valves and spool.

<http://www.chia-wang.com/EN/000002>

請考慮此王式插裝閥及工裝式換向閥之控制。

<http://www.chia-wang.com/EN/000003>

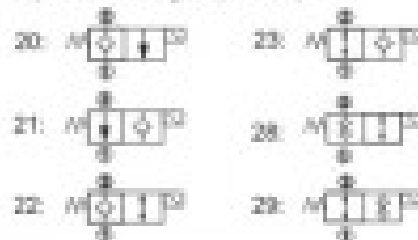

◆ DIMENSIONS 尺寸

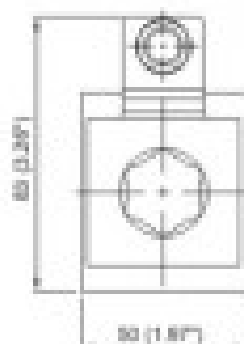

◆ Mounting Interface 安裝接口

ISO 4401-AB-03-4-A

